



#### 47 Hammond Drive Clothiers Creek NSW

4 3 3

Imagine waking up to these views everyday. Call it your private retreat!

This stunning architectural residence is situated on 11 acres of Australian rainforest, bush and orchards. Perfect to create an off-grid, sustainable lifestyle in absolute luxury.

Designed by Bush Pavilion architect, Philip Pratt, the home exudes quality and fine craftsmanship with bespoke timber joinery, windows and doors throughout. Vaulted ceilings and light filled walkways connecting the two pavilions work to capture the natural environment. The resort style infinity pool and Balinese shade hut overlook the panoramic Clothiers Creek valley and Pacific Ocean. Photos simply don't do these views or tranquility justice!

Between to the two pavilions, four bedrooms (two with en-suites), three bathrooms and a large living area open onto an expansive covered entertainment area. The wrap around decks encompass all bedrooms and entertaining areas off both sides of the home to provide flexibility through light and weather patterns. There is an

**Price** : \$ 1,480,000  
**Land Size** : 4.61 ha  
**View** : <https://www.lsproperties.com.au/sale/nsw/northern-rivers/clothiers-creek/residential/house/5929504>



**Brent Savage**  
0477 122 559

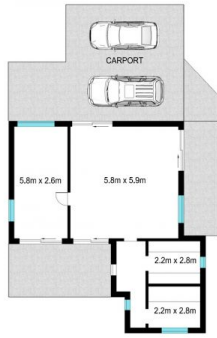

STUDIO



UPPER FLOOR



SITE PLAN

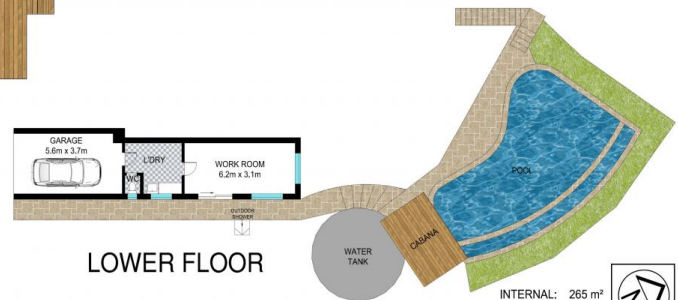

LOWER FLOOR

INTERNAL: 265 m<sup>2</sup>  
EXTERNAL: 200 m<sup>2</sup>  
STUDIO: 73 m<sup>2</sup>



Scale in meters. Indicative only. Dimensions are approximate. All information contained herein is gathered from sources we believe to be reliable. However we cannot guarantee its accuracy and interested persons should rely on their own enquiries.

47 Hammond Drive, Clothiers Creek